

vtech[®]
Baby

Parent's Guide

Chase me Bear



91-00

91-003401-015 ©

VTech understands that a child's needs and abilities change as they grow and with that in mind we develop our toys to teach and entertain at just the right level...

Pre-School

Interactive toys to develop their imagination and encourage language development

vtech Baby

Toys that will stimulate their interest in different textures, sounds and colours

I am...

...responding to colours, sounds and textures

...understanding cause and effect

...learning to touch, reach, grasp, sit-up, crawl and toddle

I want...

...to get ready for school by starting to learn the alphabet and counting

...my learning to be as fun, easy and exciting as can be

...to show my creativity with drawing and music so my whole brain develops

Electronic Learning Computers

Cool, aspirational and inspiring computers for curriculum related learning

I need...

...challenging activities that can keep pace with my growing mind

...intelligent technology that adapts to my level of learning

...National Curriculum based content to support what I'm learning at school

Birth-36 months

3-6 years

4-10 years



To learn more about this and other VTech® products, visit www.vtech.co.uk

INTRODUCTION

Thank you for purchasing **Chase me Bear**. This adorable little bear skates, spins and wobbles across the floor, encouraging your little one to dance and crawl after him. When your child gets close, Bear reacts with playful sounds and silly and encouraging phrases. Five colourful shape buttons on Bear's shirt introduce letters, numbers, colours, music and more.

On/Off/Mode
Selector



Light Up Heart

Volume Control
Switch



Shape
Buttons

Sensor Control
Switch

INCLUDED IN THIS PACKAGE

- One Chase me Bear
- One Parent's Guide

WARNING: All packing materials such as tape, plastic sheets, packaging locks, removable tags, cable ties and packaging screws are not part of this toy and should be discarded for your child's safety.

NOTE: Please keep user's manual as it contains important information.

Unlock the packaging locks:

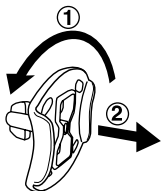

① Rotate the packaging lock anticlockwise 90 degrees.

② Pull out the packaging lock.

GETTING STARTED

BATTERY INSTALLATION

1. Make sure the unit is turned **OFF**.
2. Locate the battery cover on the bottom of the bear. Use a screwdriver to loosen the screw.
3. Install 4 new AA (LR6/AM-3) batteries following the diagram inside the battery box. (The use of new, alkaline batteries is recommended for maximum performance.)
4. Replace the battery cover and tighten the screw to secure.

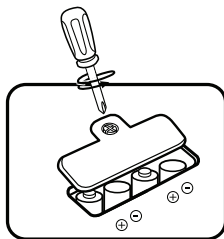

BATTERY NOTICE

- Use new alkaline batteries or fully charged NI-MH (Nickel Metal-hydride) rechargeable batteries for best performance.
- Use only batteries of the same or equivalent type as recommended.
- Do not mix different types of batteries: alkaline, standard (carbon-zinc) or rechargeable, or new and used batteries.
- Do not use damaged batteries.
- Insert batteries with the correct polarity.
- Do not short-circuit the battery terminals.
- Remove exhausted batteries from the toy.
- Remove batteries during long periods of non-use.
- Do not dispose of batteries in fire.
- Do not charge non-rechargeable batteries.
- Remove rechargeable batteries from the toy before charging (if removable).
- Rechargeable batteries are only to be charged under adult supervision.

Disposal of batteries and product



The crossed-out wheellie bin symbols on products and batteries, or on their respective packaging, indicates they must not be disposed of in domestic waste as they contain substances that can be damaging to the environment and human health.



The chemical symbols Hg, Cd or Pb, where marked, indicate that the battery contains more than the specified value of mercury (Hg), cadmium (Cd) or lead (Pb) set out in Battery Directive (2006/66/EC).

The solid bar indicates that the product was placed on the market after 13th August, 2005.

Help protect the environment by disposing of your product or batteries responsibly.

For more information, please visit:

www.recycle-more.co.uk

www.recyclenow.com

PRODUCT FEATURES

1. On/Off/Mode Selector

To turn the unit **On**, slide the **On/Off/Mode** selector to the Dancing mode 🎵 or the Catch Me mode 🐻 position. You will hear a song, a phrase and a sound. To turn the unit **Off**, slide the **On/Off/Mode** selector to the **Off** ● position.

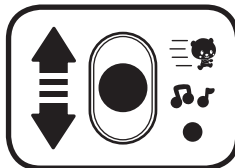

2. Volume Control Switch

To adjust the volume, slide the **Volume Control Switch** to the **Low Volume** (left speaker icon) or **High Volume** (right speaker icon) position.

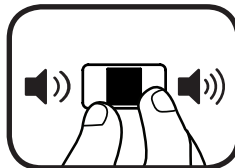

3. Sensor Control Switch

Slide the **Sensor Control switch** to the **High** (left sensor icon) or **Low** (right sensor icon) position to adjust the sensitivity of Bear's front and back sensors.

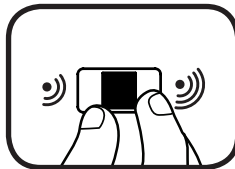

4. Automatic Shut Off

To preserve battery life, **Chase me Bear** will automatically power down after approximately 70 seconds without input. The unit can be turned on again by pressing any button.

NOTE: If the unit powers down during playing, we suggest changing the batteries.

ACTIVITIES

1. Shape Buttons

Press the five **Shape Buttons** to learn letters, numbers, shapes, colours, sing along songs and music. Bear will dance and move in response to the voice and sound responses if he is on the floor. Bear's heart will flash with the sounds.



2. Front and Back Sensors

Bear is equipped with special sensors on the front and back of his skates. Come near the sensors to activate them and see Bear skate away or dance and respond with playful phrases, music and sounds. Bear's heart will flash with the sounds.



3. Pick-Up Sensor

Bear has a special sensor on the bottom of one of his skates and knows when he has been picked up. Each time you pick up Bear, he will respond with a cute phrase. Bear's heart will flash with the sounds.





SONG LYRICS

Song 1

One, two, three, can you catch me?
I put my skates on, I'm skating away.
One, two three, come dance with me,
It would be more fun if you could join me!

Song 2

Listening to music is so sweet.
Pop music has a really fun beat.
It makes me want to move my feet.
Dancing with you is such a treat!



Song 3

I bop my head from side to side,
and wave my hands up in the air.
I move my feet and spin around,
That's how I like to boogie down.
Try it with me, boogie down!
Bop, wave, spin around!



MELODY LIST

1. Bear Went Over the Mountain
2. Good Morning Merry Sunshine
3. Humpty Dumpty
4. Here We Go Looby Loo
5. Chicken Reel
6. Old MacDonald
7. Farmer in the Dell
8. Oh! Susanna
9. Froggy Went A Courtin'
10. Skip to My Lou
11. Do You Know the Muffin Man?
12. Shoo Fly Don't Bother Me



- 
- 
13. Alphabet Song
 14. A-Tisket, A-Tasket
 15. Blow the Man Down

CARE & MAINTENANCE

- 
- 
1. Keep the unit clean by wiping it with a slightly damp cloth.
 2. Keep the unit out of direct sunlight and away from any direct heat sources.
 3. Remove the batteries when the unit is not in use for an extended period of time.
 4. Do not drop the unit on a hard surface and do not expose the unit to excess moisture.
 5. For best performance, we recommend that you use new batteries. Otherwise the unit may move slowly.
 6. We recommend that you avoid playing with the unit in bright sunlight or outdoors. Bright light will negatively affect the sensors.
 7. We recommend that you play with this unit in open spaces that are free of obstacles to prevent the toy from running into objects.
 8. For the best performance, we do not recommend playing with the unit on thick carpet or rugs. Solid, smooth surfaces are the best.
 9. If you receive an abnormal response or no response at all from the unit, please turn the unit **OFF**, replace the batteries and then turn the unit **ON** again.
 10. We recommend always playing with this toy on clean surfaces. Dirt on the wheels could cause damage to the unit.
 11. If the unit starts moving slowly, this is a sign that the batteries are low on power. We recommend replacing the batteries with an entire set of new batteries.
 12. Do not roll the unit on your child's clothing, body or hair while the toy is turned on. If something gets caught in the wheels while the unit is turned on, slide the mode selector switch to the **OFF** position.



TROUBLESHOOTING

If for some reason the program/activity stops working, please follow these steps:

1. Turn the unit **OFF**.
2. Interrupt the power supply by removing the batteries.
3. Let the unit stand for a few minutes, then replace the batteries.
4. Turn the unit back **ON**. The unit will now be ready to play again.
5. If the product still does not work, replace with an entire set of new batteries.

If the problem persists, please contact our Consumer Services Department and a service representative will be happy to help you.



CLASS 1
LED PRODUCT



CONSUMER SERVICES

Creating and developing VTech products is accompanied by a responsibility that we at **VTech®** take very seriously. We make every effort to ensure the accuracy of the information, which forms the value of our products. However, errors sometimes can occur. It is important for you to know that we stand behind our products and encourage you to call our Consumer Services Department with any problems and/or suggestions that you might have. A service representative will be happy to help you.

UK Customers:

Phone: 0330 678 0149 (from UK) or +44 330 678 0149 (outside UK)

Website: www.vtech.co.uk/support

Australian Customers:

Phone: 1800 862 155

Website: support.vtech.com.au

NZ Customers:

Phone: 0800 400 785

Website: support.vtech.com.au



PRODUCT WARRANTY/ CONSUMER GUARANTEES

UK Customers:

Read our complete warranty policy online at vtech.co.uk/warranty.

Australian Customers:

VTECH ELECTRONICS (AUSTRALIA) PTY LIMITED –
CONSUMER GUARANTEES

Under the Australian Consumer Law, a number of consumer guarantees apply to goods and services supplied by VTech Electronics (Australia) Pty Limited. Please refer to vtech.com.au/consumerguarantees for further information.

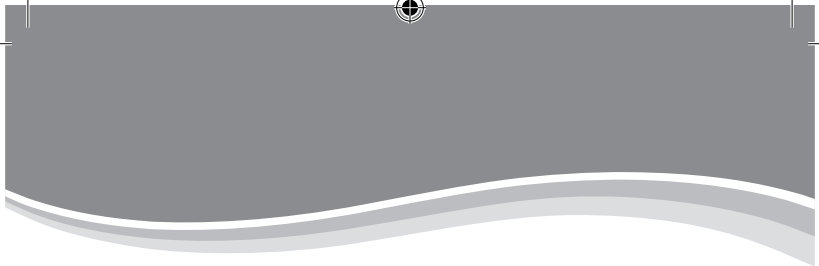

**Visit our website for more
information about our products,
downloads, resources and more.**

www.vtech.co.uk
www.vtech.com.au



TM & © 2019 VTech Holdings Limited.
All rights reserved.
Printed in China.
91-003401-015 (M)